

Introduction

This note provides an update to Progress Update No 15, dated 26th April 2019.



Speed Limits

Safety of the construction workers is the #1 priority for the entire project team, and hence the first topic of this briefing. A 50mph speed limit has been introduced on the A90 Southbound carriageway between Dolphington and Burnshot, and is in addition to the North and Southbound 40mph limits which are already in place.

ALL drivers are asked to respect these speed limits, which are in place for the safety of the workers, working to build infrastructure to improve your journey each day. Police Scotland are aware of the importance of these controls and various measures are being introduced to address the concern of speeding motorists.

Construction of Burnshot Bridge

Construction of the bridge commenced as programmed. The Contractor, Balfour Beatty is progressing well and the new bridge is due to be opened in Spring 2020.

Since site clearance works began on 1st May, the contractor has:

- Demolished the remaining existing abutments and foundations from the old bridge.
- Excavated to foundation sub-formation level (2.5m below road level) on both sides of the road.
- Placed 1m deep compacted structural fill to support the foundations.
- Placed 70mm deep blinding concrete to form a level surface for foundation construction.
- Constructed the 20m long x 5m wide x 0.8m deep reinforced concrete foundations, which were poured on 9th and 23rd July.
- Constructed the reinforced concrete columns which will support the capping beam. The West columns was poured on 19th July and the East columns were poured on 1st August.
- Installed the 'manhole sleeves' over the West columns which will contain the reinforced soil and allow the bridge to move under thermal expansion/contraction and vehicular loading.
- Commenced the installation of the reinforced soil abutment facing blocks.
- Commenced drainage installation.

Progress Photos



West - Installation of temporary sheet piles to support A90



East - Inspection of sub-formation clay



West - Placement of structural fill below foundations



West - Installation of steel reinforcement



West – Concrete delivery and pumping



West – Concrete pour in progress



West columns prior to pouring



Reinforced soil facing blocks with waterproofed manhole sleeves behind

Programme

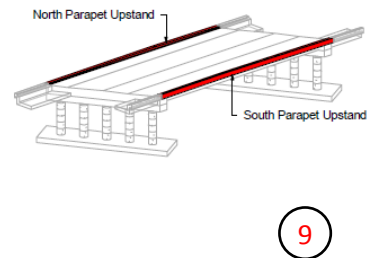
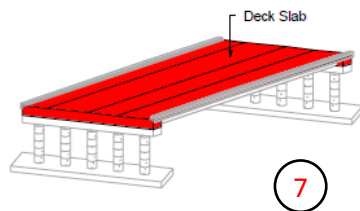
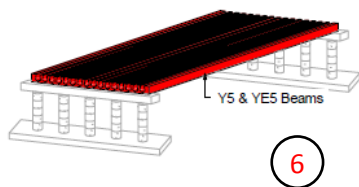
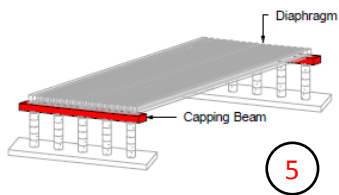
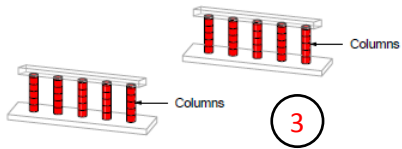
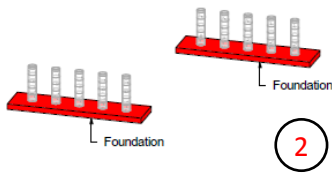

1. Demolition of existing foundations ✓
2. New concrete foundation bases ✓
3. Columns
4. Reinforced Soil abutments built around columns
5. Capping beams
6. Pre-cast concrete beams
7. Concrete bridge deck
8. Divert utilities and remove temporary bridge
9. Bridge finishes including parapets and safety fences
10. Bridge deck waterproofing and surfacing
11. Roadworks and tie-ins, including kerbs, drainage, signs and white lining
12. Bridge open to traffic (March 2020)
13. Landscaping and Environmental
14. Handover